

## Pipestone - PQN

---



- Airport Manager:** Robert Dykstra - 507-562-2473 - [rdyks@aol.com](mailto:rdyks@aol.com)
- Contact Person:** Robert Dykstra - 507-562-2473 - [rdyks@aol.com](mailto:rdyks@aol.com)
- Chamber of Com:** 507-825-3316 - [www.pipestoneminnesota.com](http://www.pipestoneminnesota.com)
- Aero Cht Coord:** 13-C
- AWOS/ASOS:** 507-825-6895 - VHF 118.375
- MnWAS Loc/Hrs:** Arrival/Departure Building - 24 hours
- Attended:** All/Mon-Fri/0800-1700
- Fuel:** 100LL, Jet A
- Self Service Fuel:** Visa, Mastercard
- After Hrs Service:** 507-562-2473
- FBO(s):** Country Aire, LLC - 507-562-2473 - 122.8 - [rdyks@aol.com](mailto:rdyks@aol.com)
- Ground Transport:** Courtesy car  
Taxi
- Food Service:** None
- Dining:** Lange's - 507-825-4488 - 1¼ miles  
Calumet Inn - 507-825-5871 - 1½ miles  
Mavericks - ½ mile  
The Villager - 1½ miles  
Dar's Pizza - 2½ miles  
Pizza Hut - 1 mile  
Pizza Ranch - 1½ miles  
McDonald's - ¾ mile
- Lodging:** Arrow Motel - 1-888-825-9599 - 1½ miles  
Super 8 Motel - 507-825-4217 - 1 mile  
Calumet Inn - 507-825-5871 or 800-535-7610 - 1½ miles
- Airport Events:** None reported
- Underwing Camp:** Yes
- Campgrounds:** Pipestone Campground - 507-825-2455
- Golf Courses:** Pipestone Country Club - 507-825-2592
- Local Attractions:** Pipestone National Monument  
County Museum  
Restored 100+ year old Calumet Inn
- Comments:** Peacepipes, pioneers & progress, Red Stone Town on the Prairie; Pipestone is the home of the stone quarries from which Indian peacepipes are made.

FIELD ELEV. 1736'

(PQN)

PIPESTONE

VICINITY MAP

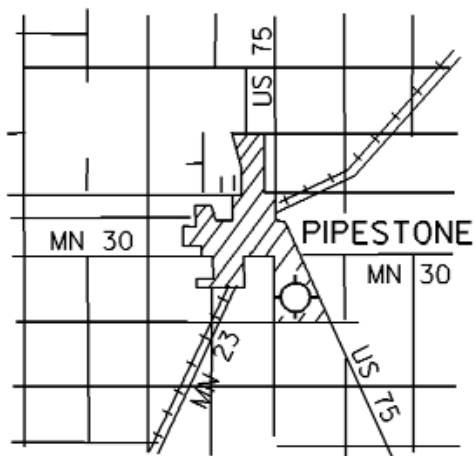

SEC. CH: OMAHA NORTH  
 LAT: 43°59.0'  
 LONG: 96°18.0'  
 COMM: CTAF: 122.8 (L)  
 AWOS: 118.375 VHF  
 MPLS CTR: 132.05  
 GCO: 121.725  
 RNAV: (FSD 115.0) R037 D28.9  
 NDB: (PQN) 284  
 DME: (PQN) 109.1 ON FLD  
 TPA: 2530' (794')  
 APPROACH: GPS & NDB  
 RNAV

TURF RWY NOT PLOWED WINTER MONTHS

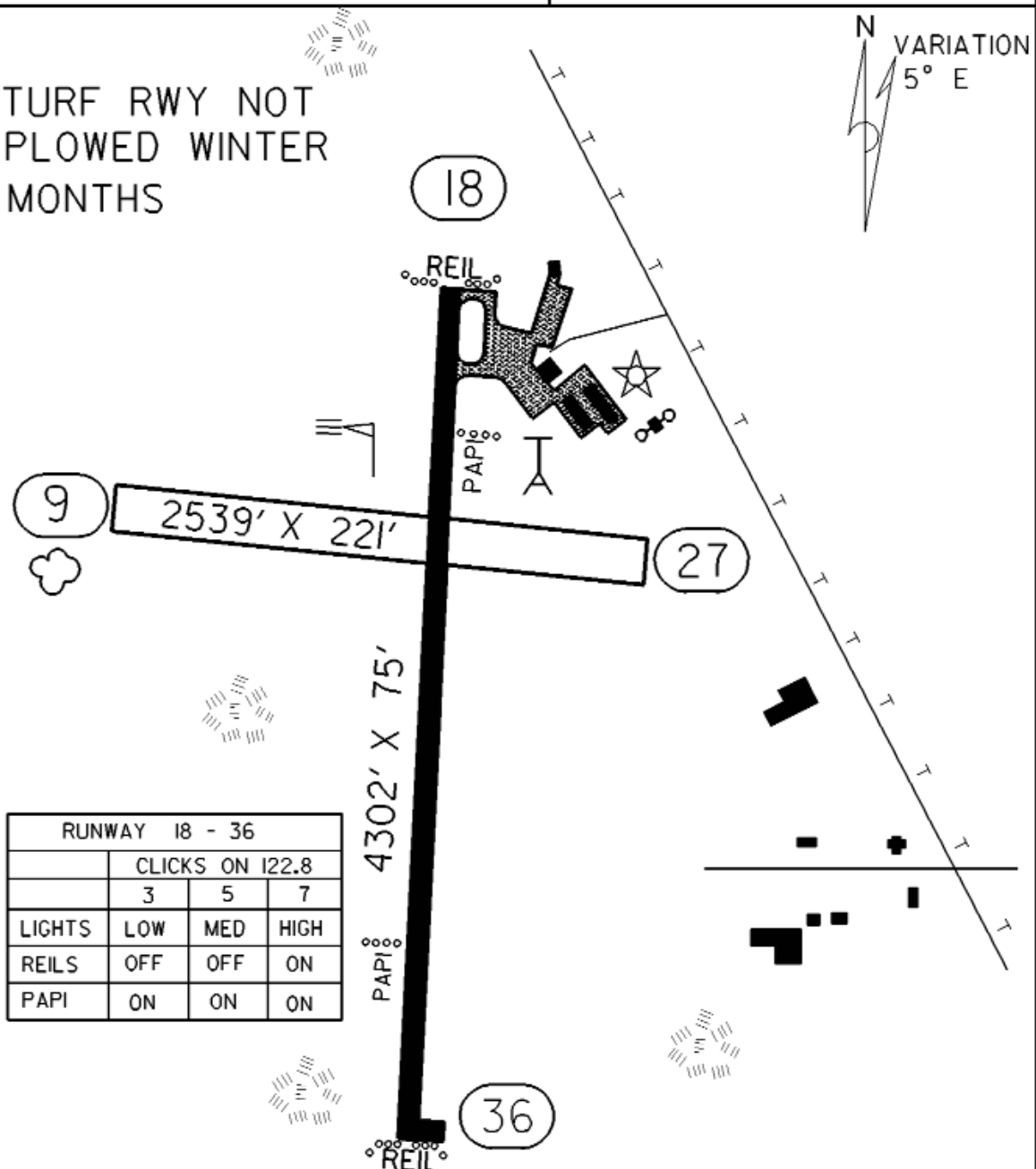

RUNWAY 18 - 36			
CLICKS ON 122.8			
	3	5	7
LIGHTS	LOW	MED	HIGH
REILS	OFF	OFF	ON
PAPI	ON	ON	ON

PIPESTONE MUNICIPAL AIRPORT

PIPESTONE