

Pinecreek - 48Y

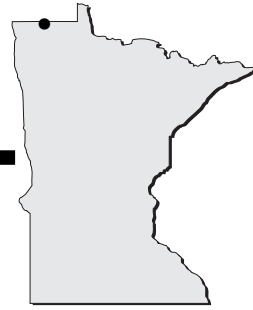

Airport Manager: Marlin Elton - 218-463-2030 - melton@wiktel.com
Contact Person: Marlin Elton - 218-463-2030 - melton@wiktel.com
AWOS/ASOS: No
MnWAS Loc/Hrs: Arrival/Departure Building - 24 hours
Attended: Unattended
Fuel: 100LL - available 24 hours with credit card
After Hrs Service: None
FBO(s): None
Businesses: None
Ground Transport: None
Food Service: None
Dining: 20 miles
Lodging: AmericInn Motel - 218-463-1045 - 20 miles
Airport Events: None reported
Underwing Camp: Yes
Campgrounds: On airport
Local Attractions: Roseau Golf Course - 20 miles
Comments: This airport is on the U.S. & Canadian Border. It is served by both U.S. Customs - 218-463-1952 & Canadian Customs Office - 204-423-2153. Calls to U.S. Customs 9:00 A.M.-5:00 P.M. Calls to Canadian Customs 9:00 A.M.-10:00 P.M. Both Customs monitor Unicom 122.8. Clearing customs requires one hour notice. If visiting the airport, a courtesy call is appreciated.

FIELD ELEV. 1082'

(48Y)

PINECREEK

VICINITY MAP

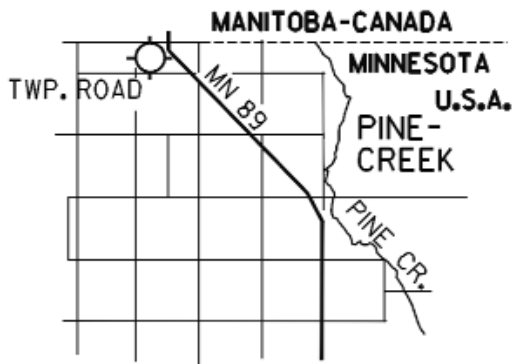

SEC. CH: TWIN CITIES (N)

LAT: 48° 60.0'

LONG: 95° 59.0'

COMM: CTAF: 122.8 (L)

MPLS CTR: 134.75

NDB: (PFT) 342

TPA: 1878' (800')

LANDING RIGHTS AIRPORT

APPROACH: GPS, NDB

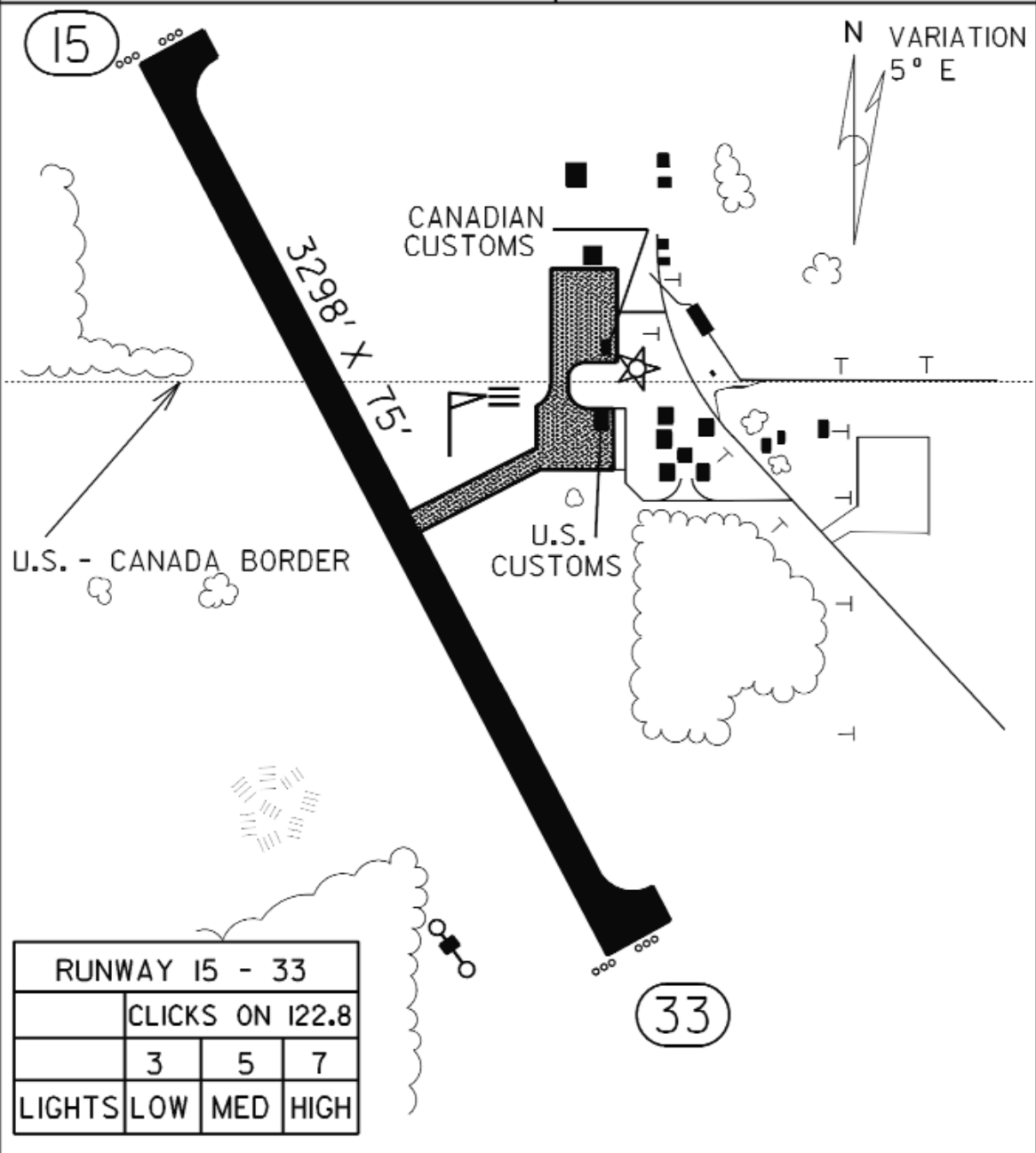

PINEY - PINECREEK BORDER AIRPORT

PINECREEK