

Orr - ORB

www.orrairport.com



- Airport Manager:** Joel Astleford - 218-757-9994 - orrmn@centurytel.net
- Contact Person:** Joel Astleford - 888-861-0628 - orrmn@centurytel.net
- AWOS/ASOS:** 218-757-3169 - VHF 118.325
- MnWAS Loc/Hrs:** Arrival/Departure Building - 24 hours
- Attended:** All/All/0900-1600
- Fuel:** 100LL, Jet A - available 24 hours with credit card
- After Hrs Service:** 888-861-0628
- FBO(s):** None
- Businesses:** None
- Ground Transport:** Rides into Orr can be provided
Local resorts will pick up at airport
- Food Service:** Pop; candy
- Dining:** The Dam Supper Club - 218-757-3985 - 1 mile
Pattenn's Café - 218-757-3908 - 2 miles
- Lodging:** Normans One Stop & Motel - 218-757-3291 - 2 miles;
North Country Inn - 218-757-3778 - 2 miles - will provide transportation;
Gateway Lodge & Suites - 800-860-3613 - will provide transportation;
numerous resorts & campgrounds
- Airport Events:** On occasion
- Underwing Camp:** Yes
- Campgrounds:** Pelican Lake - contact Voyageurs National Park & Orr Area Tourist Center at 800-357-9255 for more information
- Local Attractions:** 3 Brothers Vermilion River Greens Golf Course - 218-993-2246 - 15 miles;
Pelican Lake/Orr - fishing pier, swimming beach, tennis courts, boat, pontoon & paddle boat rentals;
Orr General Store; Wetlands Interpretative Boardwalk; Vince Shute Wildlife Sanctuary; Vermilion River Falls; sporting clays;
Upland Bird Preserve; hunting & big game hunt; Voyageurs National Park;
Crane Lake/BWCA; Kettle Falls; Namakan Lake; groomed cross-country ski trails & snowmobile trails
- Comments:** Because of its unique location to both the Voyageurs National Park & BWCA, the Orr Regional Airport is the stepping stone to some of the most diverse vacation opportunities in the nation. Jet A fuel is over-wing & single-point. Hangar sites & heated hangar space is available. Transient heated storage - 888-861-0628. Additional after hours number 218-742-5224.

FIELD ELEV. 1311'

(ORB)

ORR

VICINITY MAP

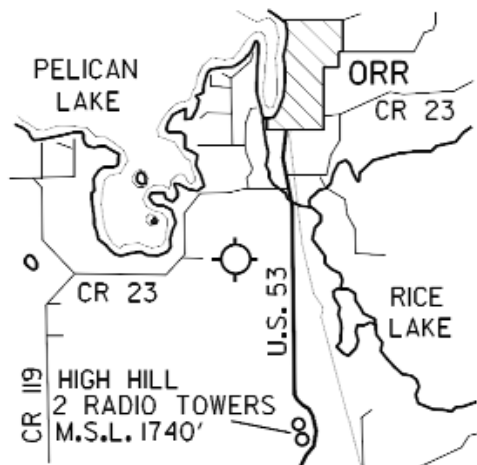

SEC. CH: GREEN BAY
 LAT: 48° 01.0'
 LONG: 92° 51.4'
 COMM: CTAF: 122.8(L)
 AWOS: 118.325 VHF
 MPLS CTR: 120.9
 GCO: 121.725
 NDB: (ORB) 341
 TPA: 2100' (789')
 APPROACH: GPS & NDB

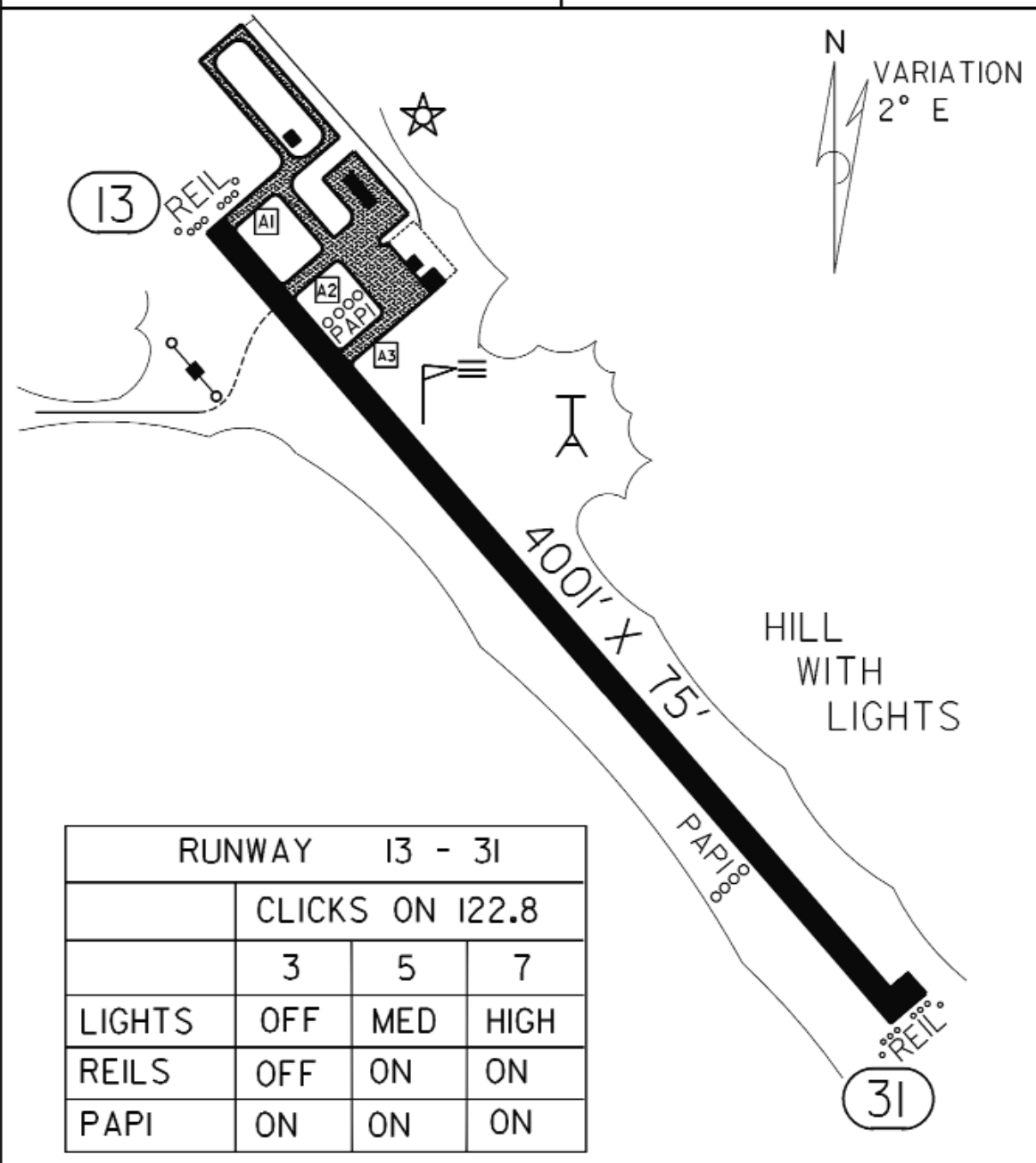

RUNWAY 13 - 31			
	CLICKS ON 122.8		
	3	5	7
LIGHTS	OFF	MED	HIGH
REILS	OFF	ON	ON
PAPI	ON	ON	ON

ORR REGIONAL AIRPORT

ORR