

Marshall - MML
www.charter-first.com

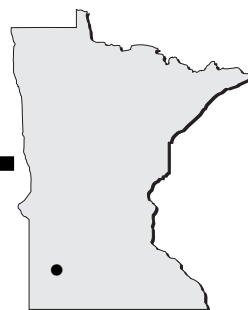

- Airport Manager:** Glenn Olson - 507-537-6773 - Glenn.Olson@marshallmn.com
- Contact Person:** Midwest Aviation - 507-532-3164 - info@charter-first.com
- AWOS/ASOS:** 507-532-5269 - VOR 111.0
- MnWAS Loc/Hrs:** Arrival/Departure Building (pilot lounge code 842) - 24 hours
- Attended:** All/Mon-Thu/0800-1800
- Fuel:** 100LL, Jet A - available 24 hours with credit card
- After Hrs Service:** 507-532-3164
- FBO(s):** Midwest Aviation Div of SW Aviation, Inc - 507-532-3164 - 122.8 - info@charter-first.com - www.charter-first.com
- Businesses:** Charter First - 507-337-0014 - sales@charter-first.com - charter-first.com
- Ground Transport:** Taxi - 507-537-7006
Rental cars - 507-532-3723 or 507-532-3291
- Food Service:** Vending machines; delivery & catering
- Dining:** Mike's Café - 507-532-5477; Hitching Post - 507-929-2228; Hunan Lion - 507-532-9733; Landmark Bistro - 507-337-6600; Perkins - 507-532-7381; Applebee's - 507-532-0080; Bagles & Brew - 507-537-0812; Shay's - 507-532-3221
- Lodging:** Ramada - 507-532-3221 - 3 miles; Comfort Inn - 507-532-3070 - 3 miles; Traveler's Lodge - 507-532-5721 - 3 miles; Super 8 Motel - 507-537-1461 - 3 miles; Deluxe Motel - 507-532-4441 - 3 miles; American Suites - 507-537-9424
- Airport Events:** None reported
- Underwing Camp:** Yes
- Campgrounds:** Camden State Park - 6 miles SW of Marshall on Highway 23; Garvin County Park - 9 miles South of Marshall on Highway 59
- Local Attractions:** Marshall Golf Club - 507-532-1622 - Holes: 18; Savanna Oaks Golf Course - 507-532-6966 - Holes: 9; Camden State Park; city parks/recreational facilities; July Fourth Kite Celebration
- Comments:** Additional after hours service phone - 507-532-3164
Additional airport manager's phone - 507-537-6706

FIELD ELEV. 1183'

(MML)

MARSHALL

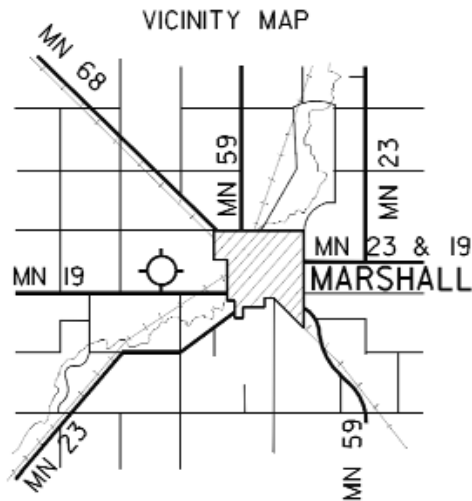

SEC. CH: OMAHA NORTH
 LAT: 44° 27.1'
 LONG: 95° 49.5'
 COMM: CTAF: 122.8(L)
 AWOS: 111.0 VOR
 RCO FSS: 122.35
 MPLS CTR: 127.1
 GCO: 121.725
 TPA: 1970' (787')
 APPROACH: ILS, GPS,
 RNAV, VOR/DME & VOR

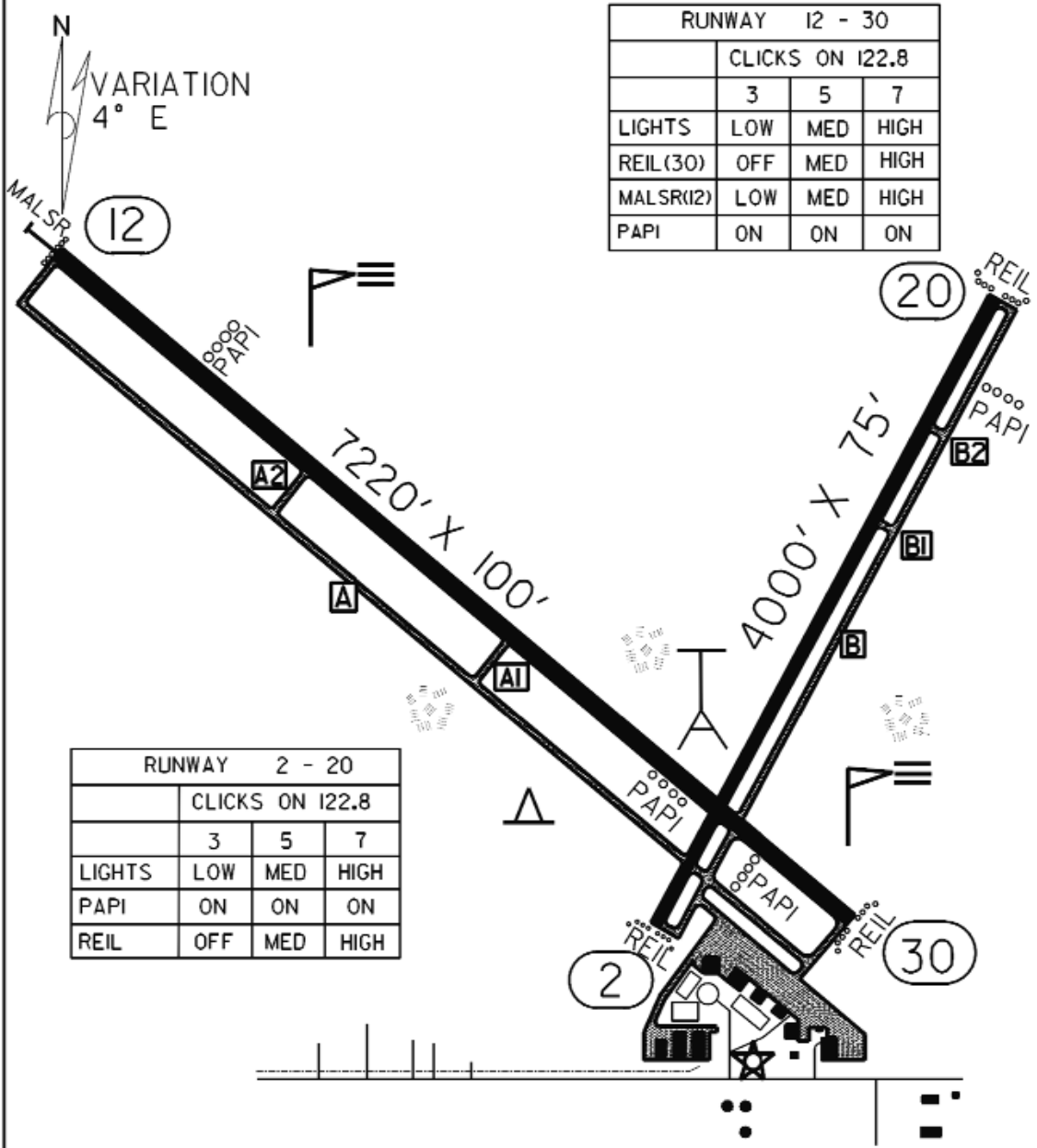

SOUTHWEST MINNESOTA REGIONAL AIRPORT-MARSHALL (RYAN FIELD)

MARSHALL