

## Mahnomen - 3N8

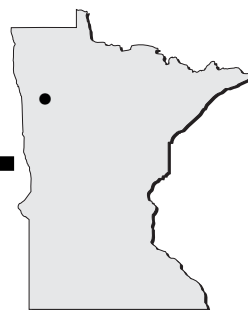

---

**Airport Manager:** Bill Nelson - 218-935-5650  
**Contact Person:** Mike Nelson - 218-935-5076  
**Chamber of Com:** 218-935-2573  
**Aero Cht Coord:** 6-D  
**AWOS/ASOS:** No  
**MnWAS Loc/Hrs:** NA  
**Attended:** Unattended  
**Fuel:** 100LL  
**Self Service Fuel:** No  
**After Hrs Service:** 218-935-5650  
**FBO(s):** Crawford Aviation - 701-261-8378  
**Ground Transport:** Limo service from the airport any time of day - 218-935-2711  
**Food Service:** None  
**Dining:** Shooting Star Casino - 800-453-STAR - 4½ miles  
Red Apple Café - 218-935-9918  
Pinehurst Resort Dining Room - 218-935-5745  
Hilltop Supper Club - 218-473-2652  
**Lodging:** Shooting Star Casino - 800-453-STAR - 4½ miles  
Stardust Suites - 218-935-2761 - 4½ miles  
Pinehurst Resort - 218-935-5745  
**Airport Events:** None reported  
**Underwing Camp:** Yes  
**Campgrounds:** R.V. camping at casino  
Camping at fairgrounds  
**Golf Courses:** Mahnomen Country Club - 218-935-5188 - 5 miles  
**Local Attractions:** Indoor swimming pool & tennis court at school and at the Casino; many resorts around the Mahnomen area. Golden Eagle Bingo - 218-935-5385.  
Shooting Star Casino - 800-453-STAR. Gateway to Itasca State Park.  
**Comments:** Call in advance for fuel. Mahnomen Airport has free tiedowns. The Casino will pick up at the airport any time of the day, seven days a week - use phone in the airport office & call 218-935-2711. For current local weather information go to [www.rwis.dot.state.mn.us](http://www.rwis.dot.state.mn.us), click on District 4 and then T.H. 59.  
Runway 9/27 will not be plowed in the winter months, but it can be used for ski flying.

FIELD ELEV. 1244'

(3N8)

MAHNOMEN

VICINITY MAP

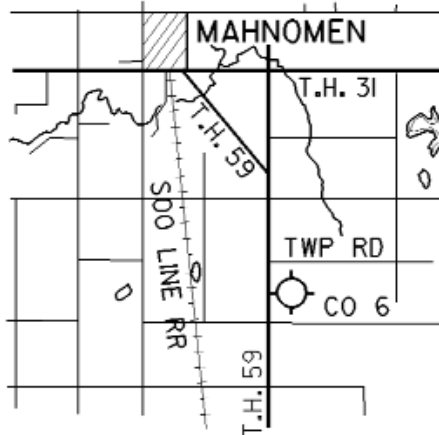

SEC. CH: TWIN CITIES (N)  
 LAT: 47° 15.6'  
 LONG: 95° 55.8'  
 COMM: CTAF: 122.9  
 MPLS CTR: 134.75  
 RNAV: (DTL III.2) R350 D30.6  
 TPA: 1800' (556')



N VARIATION  
 5° E

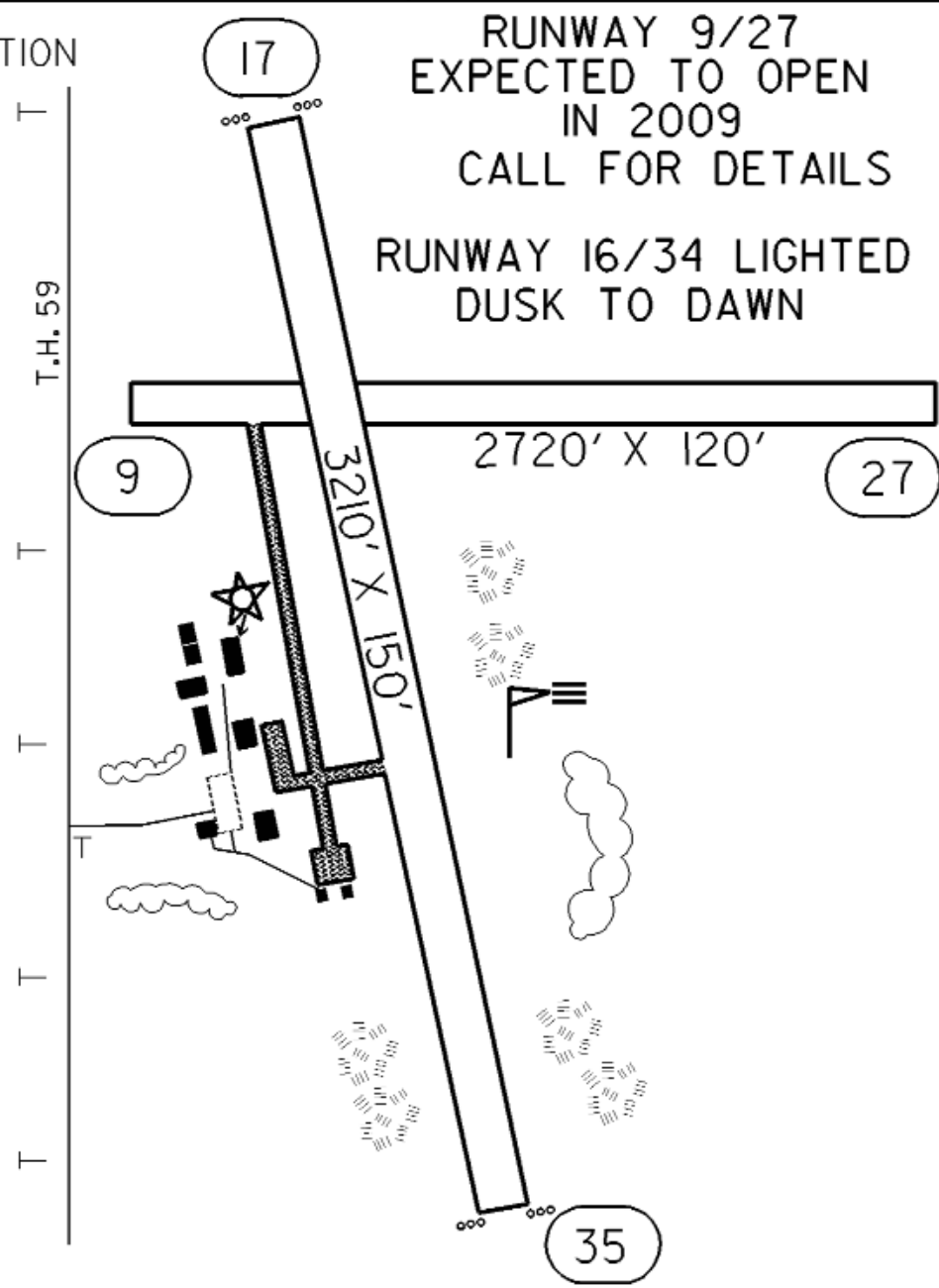

RUNWAY 9/27  
 EXPECTED TO OPEN  
 IN 2009  
 CALL FOR DETAILS

RUNWAY 16/34 LIGHTED  
 DUSK TO DAWN

MAHNOMEN COUNTY AIRPORT

MAHNOMEN