

Lino Lakes - 8Y4

www.adventureseaplane.com

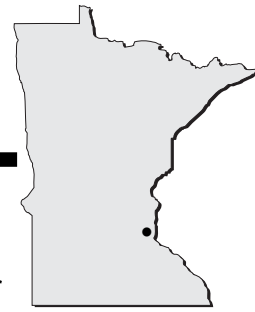

- Airport Manager:** Bruce R. Hanson - 651-780-4179
N70ky@yahoo.com
- Contact Person:** Bruce R. Hanson or Cherie Burger
651-780-4179 -
N70ky@yahoo.com
- AWOS/ASOS:** No
- MnWAS Loc/Hrs:** Main Office - same as attendance schedule
- Attended:** May-Oct/All/Dawn-Dusk
- Fuel:** 100LL - after hours call 651-792-4703
- After Hrs Service:** 651-792-4703
- FBO(s):** Seaplane Services, Inc. - 651-792-4703 - 122.9 -
seaplane@isd.net - www.seaplaneservices.com
- Businesses:** Adventure Bound Seaplanes, Inc. - 763-783-2498 -
fly@adventureseaplanes.com -
www.adventureseaplanes.com
- Ground Transport:** Yes
- Food Service:** None
- Dining:** Matthew's Family Restaurant - 1 mile; Ta's - 1 mile
Pizza Hut - 1 mile; Miller's On Main - 2 miles; Burger
King - 2 miles; Subway - 2 miles; McDonald's -
2 miles; Dairy Queen - 2 miles; Trappers Bar &
Restaurant (on the lake)
- Lodging:** Mounds View Inn - 5 miles; Comfort Inn - 1½ miles
- Airport Events:** Seaplane Pilots Annual Picnic - August
- Underwing Camp:** Yes
- Campgrounds:** On site; Rice Creek/Chain of Lakes Regional Park -
651-426-7564
- Local Attractions:** Chomonix Golf Course - 1 mile; canoeing; fishing;
Shoreview Community Center - 5 miles; public
library - 1 mile
- Comments:** Rice Lake Elementary School is on the south side of
the lake. Approach & departure to & from the west
contact Anoka Control Tower on 132.4. Make
approach & departure over adjoining lakes when
possible.

WATER ELEV. 880'

(8Y4)

LINO LAKES

VICINITY MAP

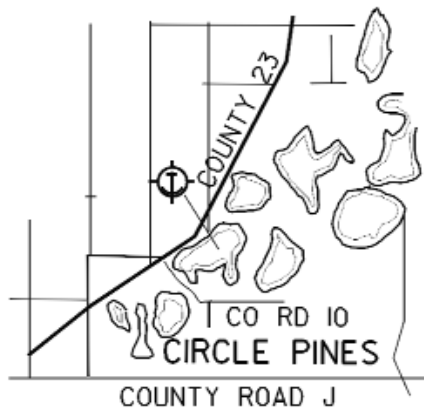

N
 SEC. CH: TWIN CITIES (S)
 LAT: 45° 09.0'
 LONG: 93° 07.0'
 COMM: CTAF: 122.9
 RCO FSS: 122.55
 MPLS APP: 126.5
 TPA: 1480' (600')



N



VARIATION
3° E

THIS SEAPLANE BASE UNDERLIES
 THE MPLS CLASS 'B' AIRSPACE
 AND IS ADJACENT TO THE
 ANOKA CO. CLASS 'D' AIRSPACE

LANDING STRIP NOT
 FOR PUBLIC USE

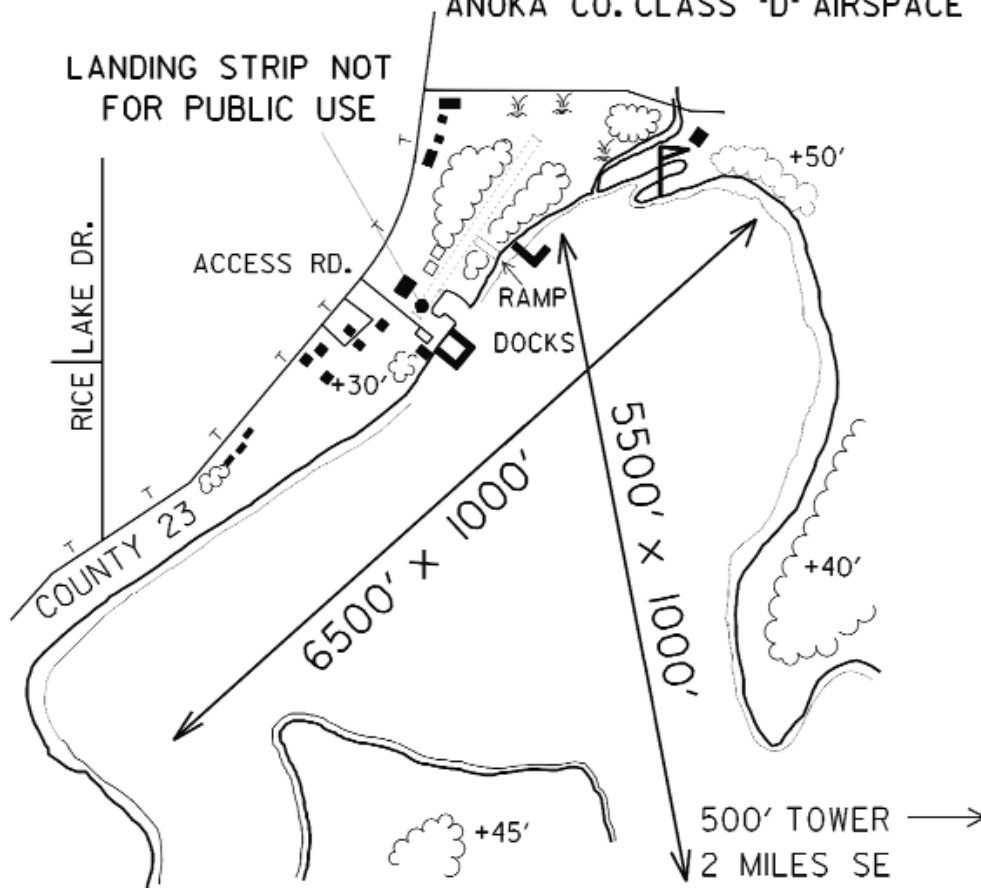

NO TAKEOFFS OR LANDINGS
 OVER RESIDENTIAL AREAS

SURFSIDE SEAPLANE BASE
 RICE LAKE

LINO LAKES