

Hibbing - 9MNØ

www.rangeregionalairport.com

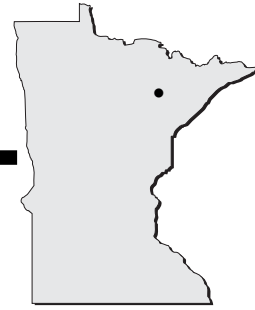

- Airport Manager:** Shaun Germolus - 218-262-3452 - shaun@rangeregionalairport.com
- Contact Person:** Barrett Ziemer - 218-262-3451 - chaa@rangeregionalairport.com
- AWOS/ASOS:** 218-263-8384 - VHF 126.425
- MnWAS Loc/Hrs:** NA
- Attended:** Unattended
- Fuel:** None
- After Hrs Service:** None
- FBO(s):** Hibbing Fueling Facility - 218-263-4353 - fuel@rangeregionalairport.com - www.rangeregionalairport.com
- Businesses:** None
- Ground Transport:** Hibbing Taxi - 218-263-5065
ACAR - Auto Rental - 218-263-8943
Hertz - 218-263-6435
- Food Service:** None
- Dining:** Airway Inn - 218-263-9801 - 2 blocks
- Lodging:** Super 8 Motel - 218-263-8982 - 3 miles
Hibbing Park Hotel - 218-262-3481
- Airport Events:** None reported
- Underwing Camp:** No
- Campgrounds:** None reported
- Local Attractions:** Municipal Golf Course; Mesaba Country Club & Golf Course; Giants Ridge Golf & Ski Resort; Minnesota Discovery Center; Hull Rust Mine
- Comments:** Chisholm Area Chamber of Commerce - 800-422-0806
MnWAS located at airport - Hibbing Fueling Facility
- Restrictions:**
1. Seaplane traffic will monitor and make traffic calls on the Range Regional (Hibbing) Airport CTAF.
 2. Aircraft landing at the airport shall have preference over seaplane traffic.
 3. Seaplane traffic shall fly a 500 foot AGL traffic pattern and avoid conflict with traffic landing at the Range Regional (Hibbing) Airport.
 4. Seaplane traffic departing to the South will make a left hand turn before Herman Road and remain north of the airport until safely clear of the airport traffic area.

WATER ELEV. 1351'

(9MNØ)

HIBBING

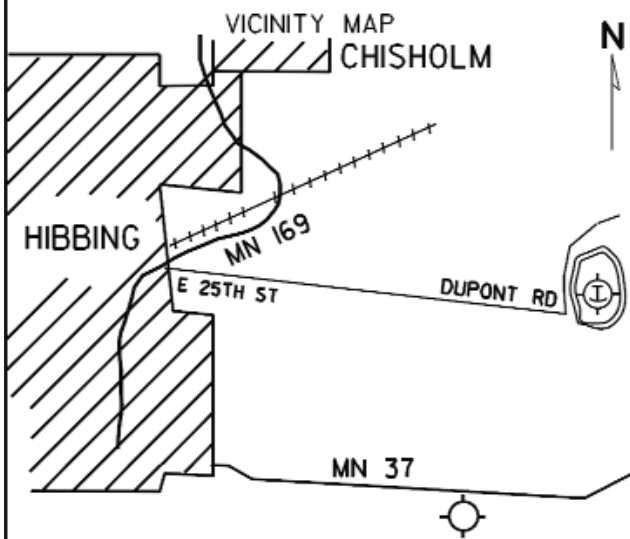

N

SEC. CH: GREEN BAY
 LAT: 47° 25.1'
 LONG: 92° 49.7'
 COMM: CTAF: 123.0
 ASOS: 126.425 VHF
 TPA: 1851' (500')



ANY PERSON DESIRING TO USE CAREY LAKE SEAPLANE BASE MUST HOLD AT LEAST A PRIVATE PILOT CERTIFICATE WITH A SEAPLANE RATING AND SHALL OBTAIN THE PRIOR PERMISSION OF THE RANGE REGIONAL (HIBBING) AIRPORT MANAGER FOR EACH LANDING AND TAKEOFF.

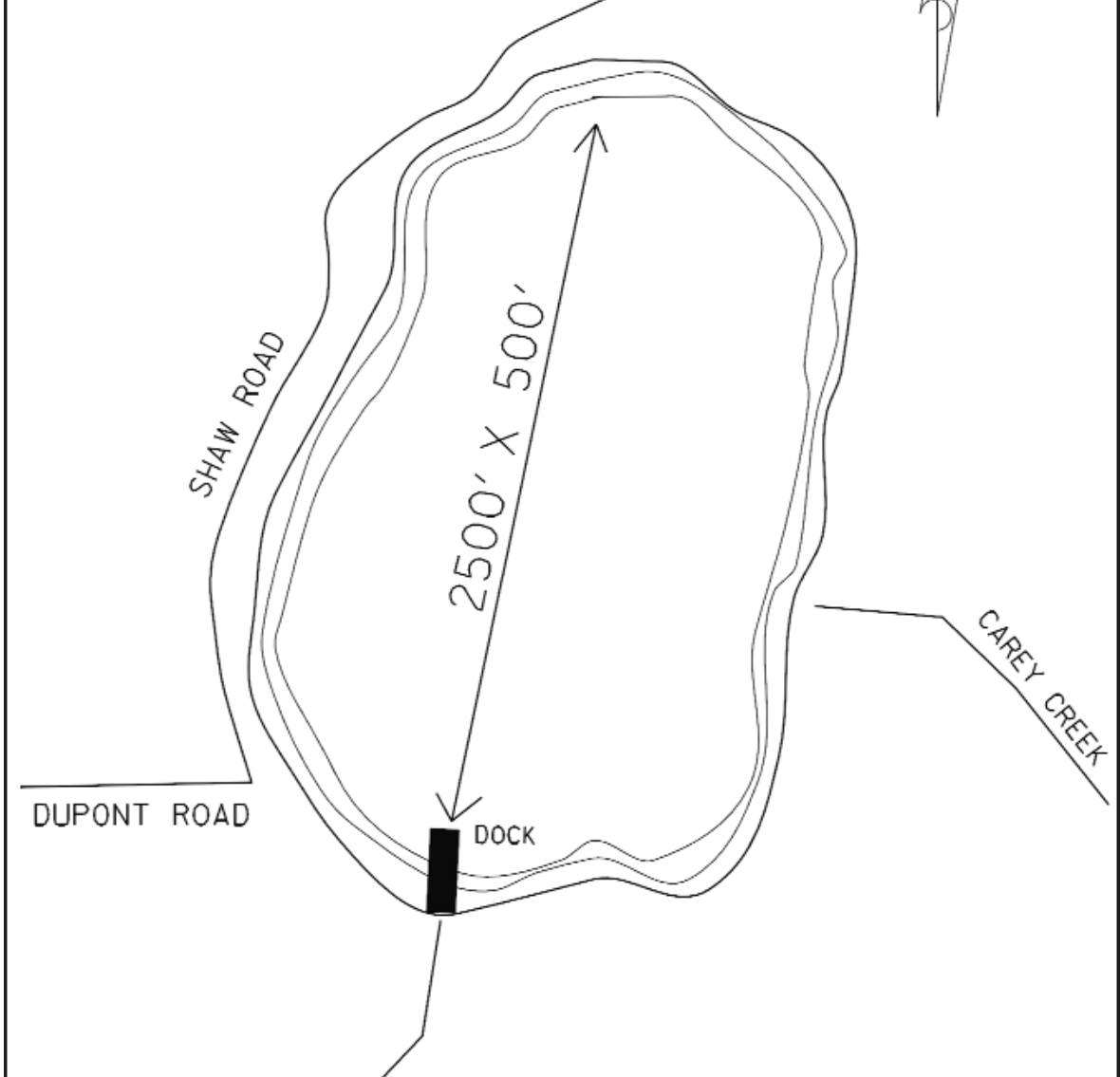
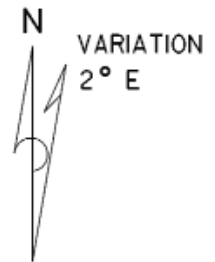

CAREY LAKE SEAPLANE BASE

HIBBING