

Grygla - 3G2

www.grygla.govoffice2.com

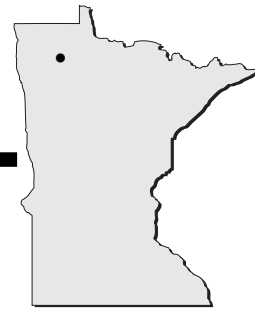

Airport Manager: Carter Torgerson - 218-294-6728 - cityofgrygla@gvtel.com

Contact Person: Carter Torgerson - 218-689-3271 - cityofgrygla@gvtel.com

AWOS/ASOS: No

MnWAS Loc/Hrs: NA

Attended: Unattended

Fuel: None

After Hrs Service: 218-689-3271

FBO(s): None

Businesses: None

Ground Transport: None

Food Service: None

Dining: Yo-Hawn's - 218-294-6197 - ¼ mile
The Grain Bin Café & Gift Shop - 218-294-6306 - ½ mile
Diamond's - 218-294-6359 - ½ mile

Lodging: Motel 89 - 218-294-6158 - ¾ mile

Airport Events: Fly-In - call for details

Underwing Camp: Yes

Campgrounds: Grygla Park - 1 block

Local Attractions: Hunting
Snowmobiling
Sightseeing
Minnesota's only wild elk herd

Comments: City of Grygla web site - www.grygla.govoffice2.com

FIELD ELEV. 1177'

(3G2)

GRYGLA

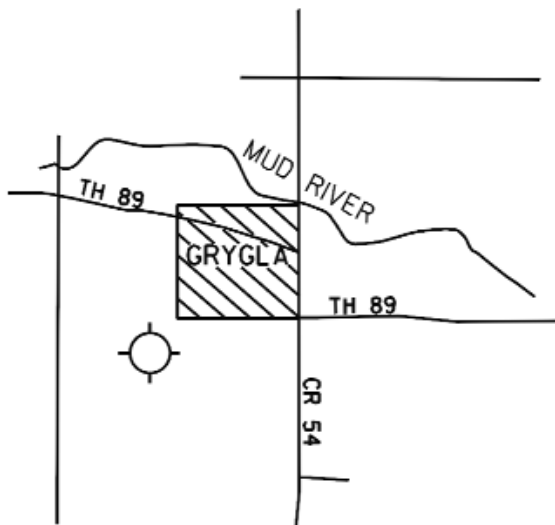

SEC. CH: TWIN CITIES (N)
 LAT: 48°17.7'
 LONG: 95°37.6'
 COMM: CTAF: 122.9
 TPA: 2177' (1000')

N

VARIATION
4° E



RUNWAY LIGHTED
DUSK TO DAWN

TOWNSHIP ROAD

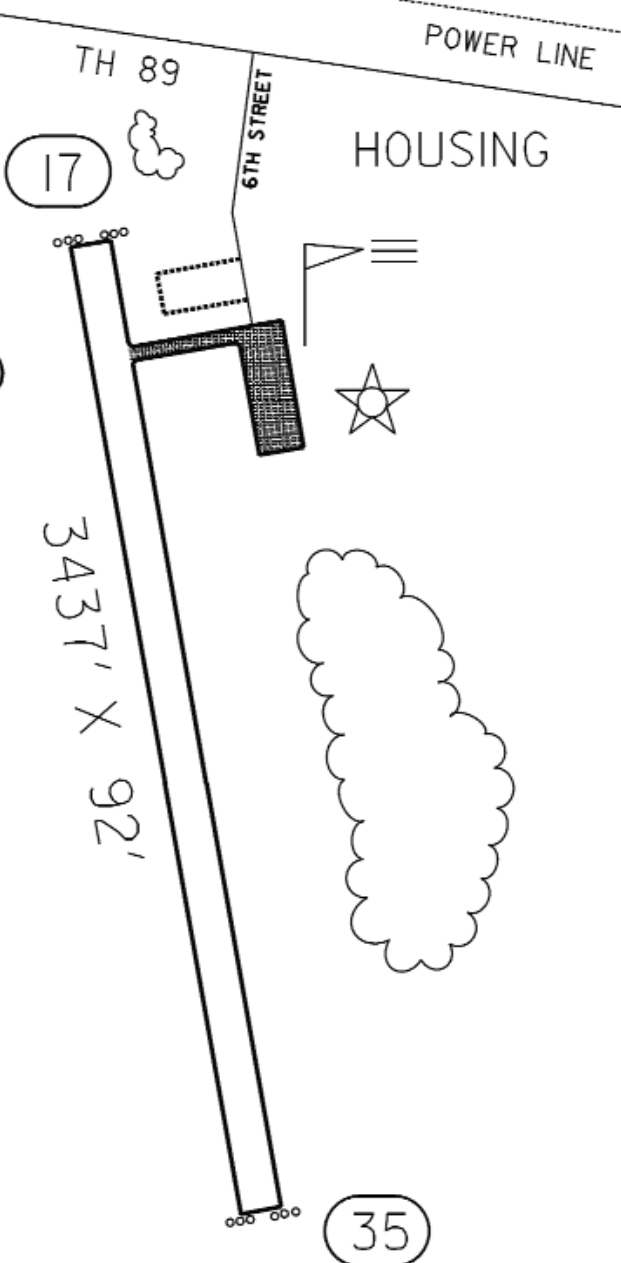

GRYGLA MUNICIPAL AIRPORT
(MEL WILKENS FIELD)

GRYGLA