

Grand Rapids

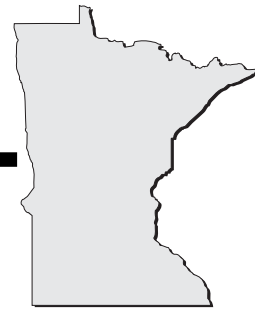

Airport Manager: John Persons/Nancy Miller -
218-326-0332 -
millerpersons@mchsi.com

Contact Person: John Persons/Nancy Miller -
218-326-3040 -
millerpersons@mchsi.com

AWOS/ASOS: None

MnWAS Loc/Hrs: NA

Attended: May-Oct/All/Dawn-Dusk

Fuel: 100LL - after hours call - 218-326-0332

After Hrs Service: 218-326-0332

FBO(s): None

Businesses: None

Ground Transport: None

Food Service: Snack Bar

Dining: None

Lodging: None

Airport Events: None reported

Underwing Camp: No

Campgrounds: None

Golf Courses: None

Local Attractions: None

Comments: None

WATER ELEV. 1273'

()

GRAND RAPIDS

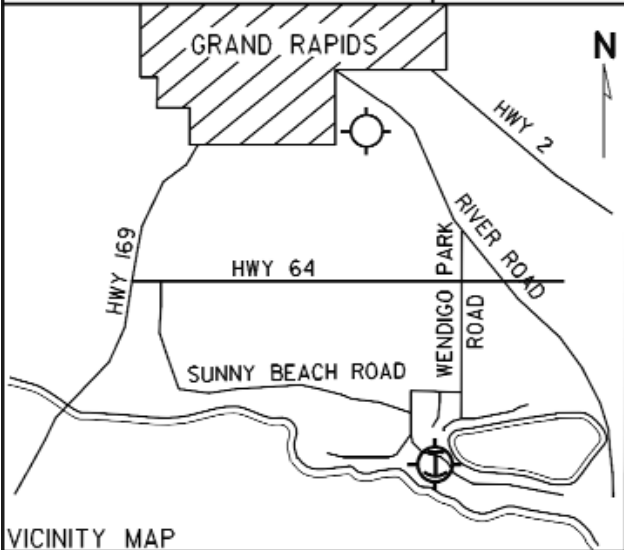

SEC. CH: TWIN CITIES (N)
 LAT: 47° 08.4'
 LONG: 93° 28.3'
 COMM: CTAF: 122.9
 MPLS CTR: 127.9
 RCO FSS: 122.05
 TPA: 2073' (800')



VICINITY MAP

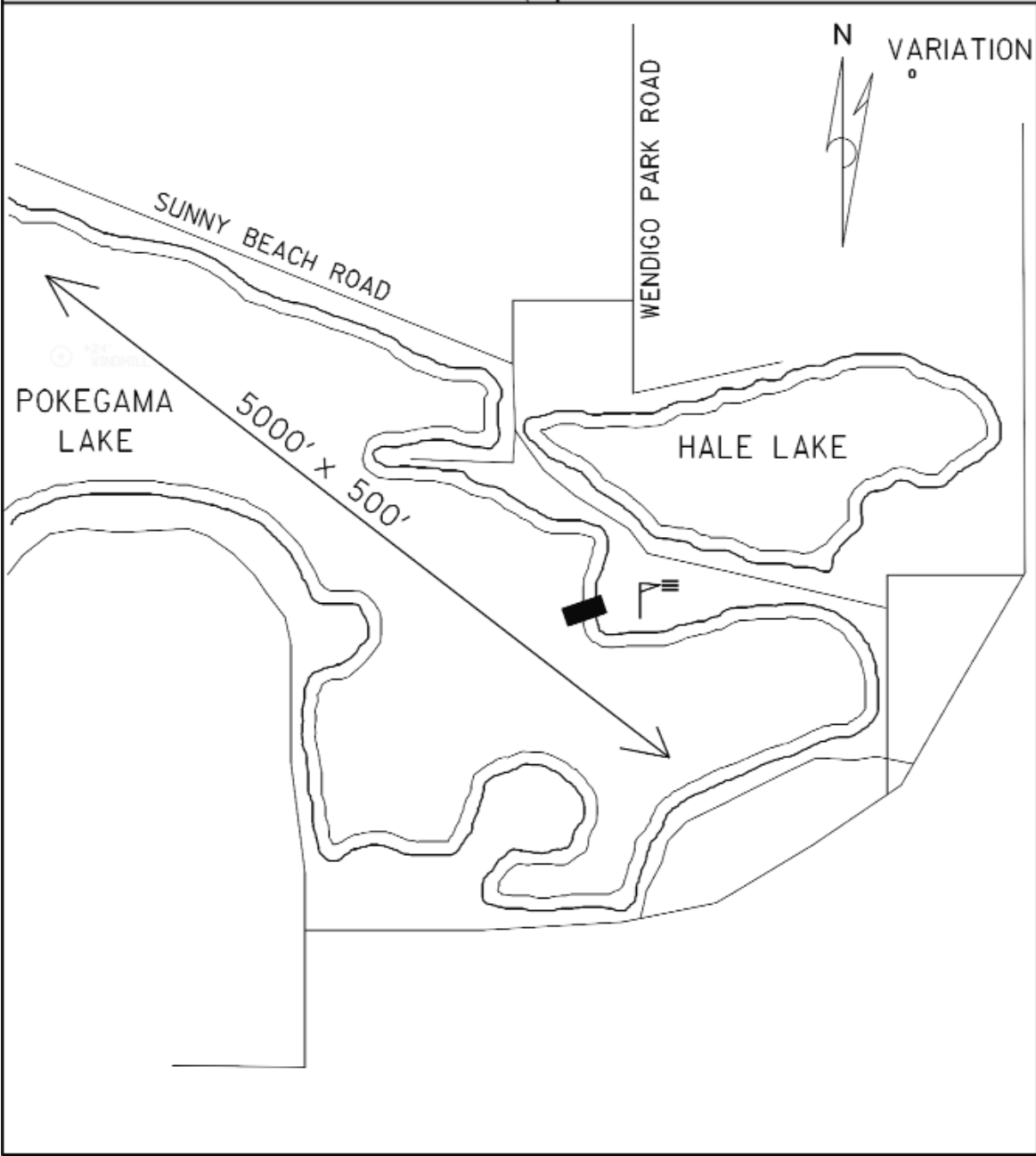

BAYSIDE MARINA SEAPLANE BASE GRAND RAPIDS