

## Cook - CQM

---

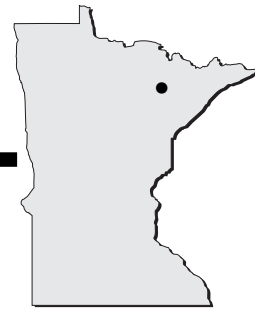

- Airport Manager:** Tom Woock - 218-666-2909 -  
airport@cookmn.us
- Contact Person:** Ernie Seppala - 218-666-9931
- AWOS/ASOS:** 218-666-2539 - VHF 118.175
- MnWAS Loc/Hrs:** Arrival/Departure Building - 24 hours
- Attended:** All/All/0900-1300
- Fuel:** 100LL, Jet A - available 24 hours with credit card
- After Hrs Service:** 218-666-9931
- FBO(s):** None
- Businesses:** None
- Ground Transport:** Waschke Family Chevrolet - Rental - 218-666-5901  
Luxury Limousine - 888-436-3238
- Food Service:** Snacks
- Dining:** South Switch; Montana Café; McDonald's; Subway -  
2 miles
- Lodging:** Vermilion Motel - 218-666-2272 - 2 miles - shuttle  
service  
Lake Resorts - shuttle service - call Chamber of  
Commerce for details - 800-648-5897
- Airport Events:** None reported
- Underwing Camp:** Yes
- Campgrounds:** State & Federal Parks  
Private campgrounds - call Chamber of Commerce  
for details - 800-648-5897
- Local Attractions:** Vermilion Fairways - 5 miles - Holes: 9; Wolfridge  
Golf Course- 5 miles; The Wilderness (Fortune Bay  
Casino) Golf Course - Holes: 18; Lake Vermilion;  
Elbow Lake; Vermilion River; Crane Lake; BWCA;  
Voyageurs; state & national parks; Giant's Ridge  
Recreational Area; International Wolf Center;  
Soudan Underground Mine Tours; Ironworld;  
Fortune Bay Casino; U.S. Forest Service Visitor  
Center; Laurentian Environmental Center; Orr Bog  
Walk; wilderness & civilized camping; boats; canoes;  
seaplane rides; fishing; hunting; guides & outfitters;  
snowmobiles; cross-country skiing on lakes & trails;  
Alpine skiing; ice fishing; shops; movie theater;  
library; friendly people
- Comments:** Additional airport contact phone - 866-875-3736

FIELD ELEV. 1327'

(COM)

COOK

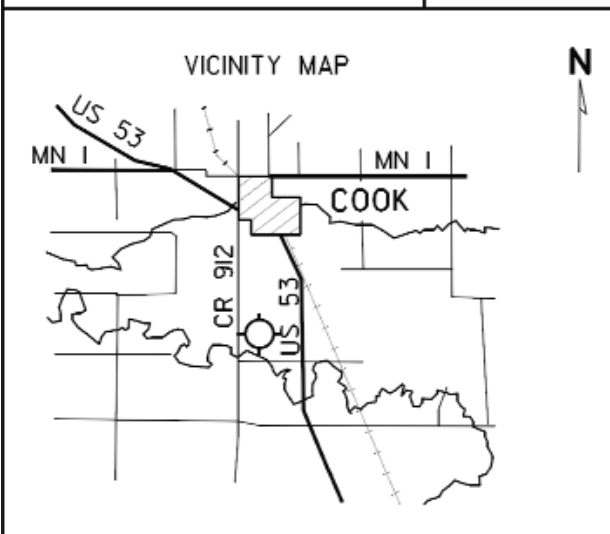

SEC. CH: GREEN BAY NORTH  
 LAT: 47° 49.3'  
 LONG: 92° 41.4'  
 COMM: CTAF: 122.9 (L)  
 AWOS: 118.175 VHF  
 FSS (EVELETH RCO): 122.45  
 TPA: 2327' (1000')  
 APPROACH: RNAV, GPS

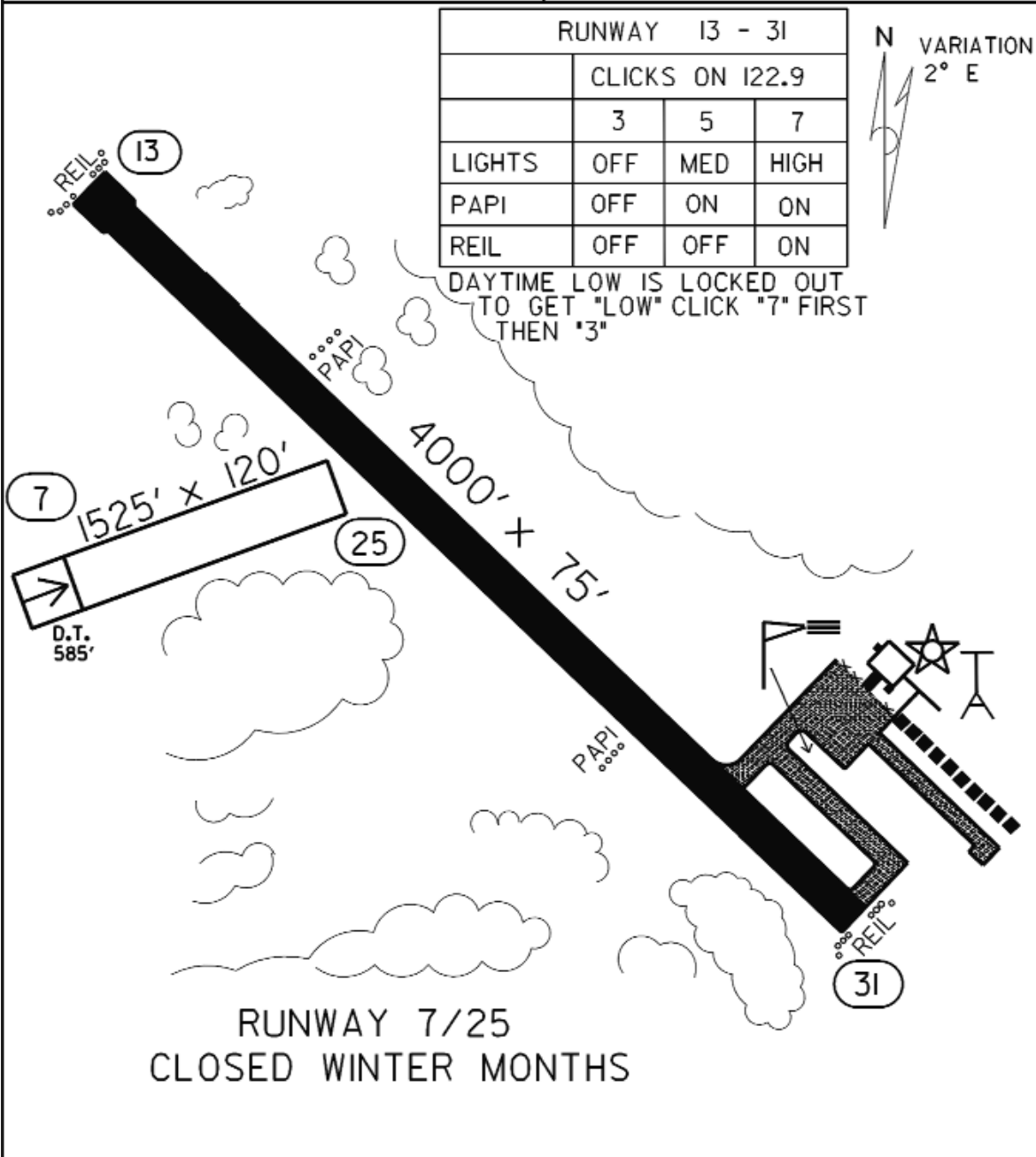

COOK MUNICIPAL AIRPORT

COOK