

**Cloquet - COQ**  
**www.cloquetairport.com**

---

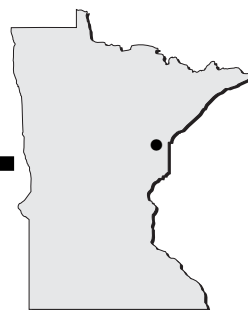

- Airport Manager:** Quinten Anderson - 218-879-4911  
quinten@cloquetairport.com
- Contact Person:** Mark Linne - 218-384-9150 -  
mark.linne@co.carlton.mn.us
- Chamber of Com:** 800-554-4350 - www.cloquet.com
- Aero Cht Coord:** 7-J
- AWOS/ASOS:** 218-879-0783 - VHF 118.525
- MnWAS Loc/Hrs:** Arrival/Departure Building - 24 hours
- Attended:** All/Mon-Sat/0800-1700
- Fuel:** 100LL, Jet A
- Self Service Fuel:** All major credit cards
- After Hrs Service:** 218-591-6157
- FBO(s):** Woodland Aviation - 218-878-1230 -  
fly@woodlandaviation.biz - www.woodlandaviation.biz
- Ground Transport:** Taxi  
Bicycles
- Food Service:** Pop machine; candy
- Dining:** Carmen's - 218-879-1889 - 1 mile  
Perkins - 218-879-8380 - 2 miles  
Applebee's - 218-879-4790 - 2 miles  
Black Bear Casino - 218-878-2327 - 5 miles
- Lodging:** AmericInn Motel - 218-879-1231 - 2 miles  
Super 8 Motel - 218-879-1250 - 2 miles  
Black Bear Hotel - 218-878-7400 - 5 miles
- Airport Events:** Annual EAA Chapter 1221 Fly-In
- Underwing Camp:** Yes
- Campgrounds:** KOA - 218-879-5726 - 5 miles  
The Lounge on Big Lake - 218-879-1819 - 6 miles
- Golf Courses:** Cloquet Country Club - 218-879-7997 - 2 miles  
Big Lake Golf - 218-879-4221 - 7 miles  
Black Bear Golf Course - 218-878-8633
- Local Attractions:** Black Bear Casino; Carlton County Historical Museum;  
Cloquet Forestry Center; Fond Du Lac Community  
College; Fond Du Lac Indian Reservation; historical  
walking tour; Jay Cook State Park; local industry tours -  
Jarden Home Brands; SAPPI; USG (call Cloquet  
Chamber to set up tour); Chamber of Commerce  
headquarters; public library; white water rafting;  
campground - Stafford Island - West of Highway 33 in  
Cloquet
- Comments:** Manager's FAX - 218-879-0120  
Deer in the vicinity of airport  
EAA Chapter 1221 - www.eaachapter1221.com  
When Duluth approach is closed contact MPLS CTR -  
127.9

FIELD ELEV. 1279'

(COQ)

CLOQUET

VICINITY MAP

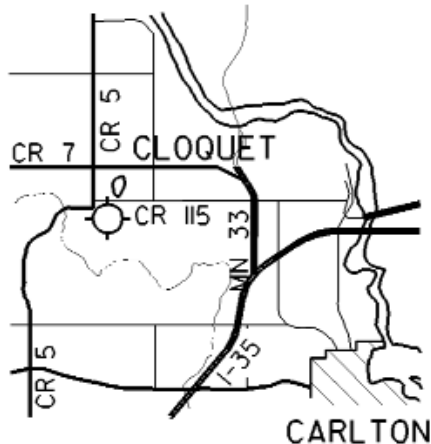

SEC. CH: GREEN BAY (N)  
 LAT: 46° 42.1'  
 LONG: 92° 30.2'  
 COMM: CTAF: 122.8 (L)  
 AWOS: 118.525 VHF  
 DLH APP: 125.45  
 DLH CLNC DEL: 122.15  
 MPLS CTR: 127.9  
 RNAV: (DLH 112.6) R239 D13.8  
 NDB: (COQ) 335  
 TPA: 2270' (991')  
 APPROACH: GPS, NDB,  
 RNAV, VOR/DME

2270' MINIMUM  
 ALTITUDE ADVISORY  
 OVER SCHOOL

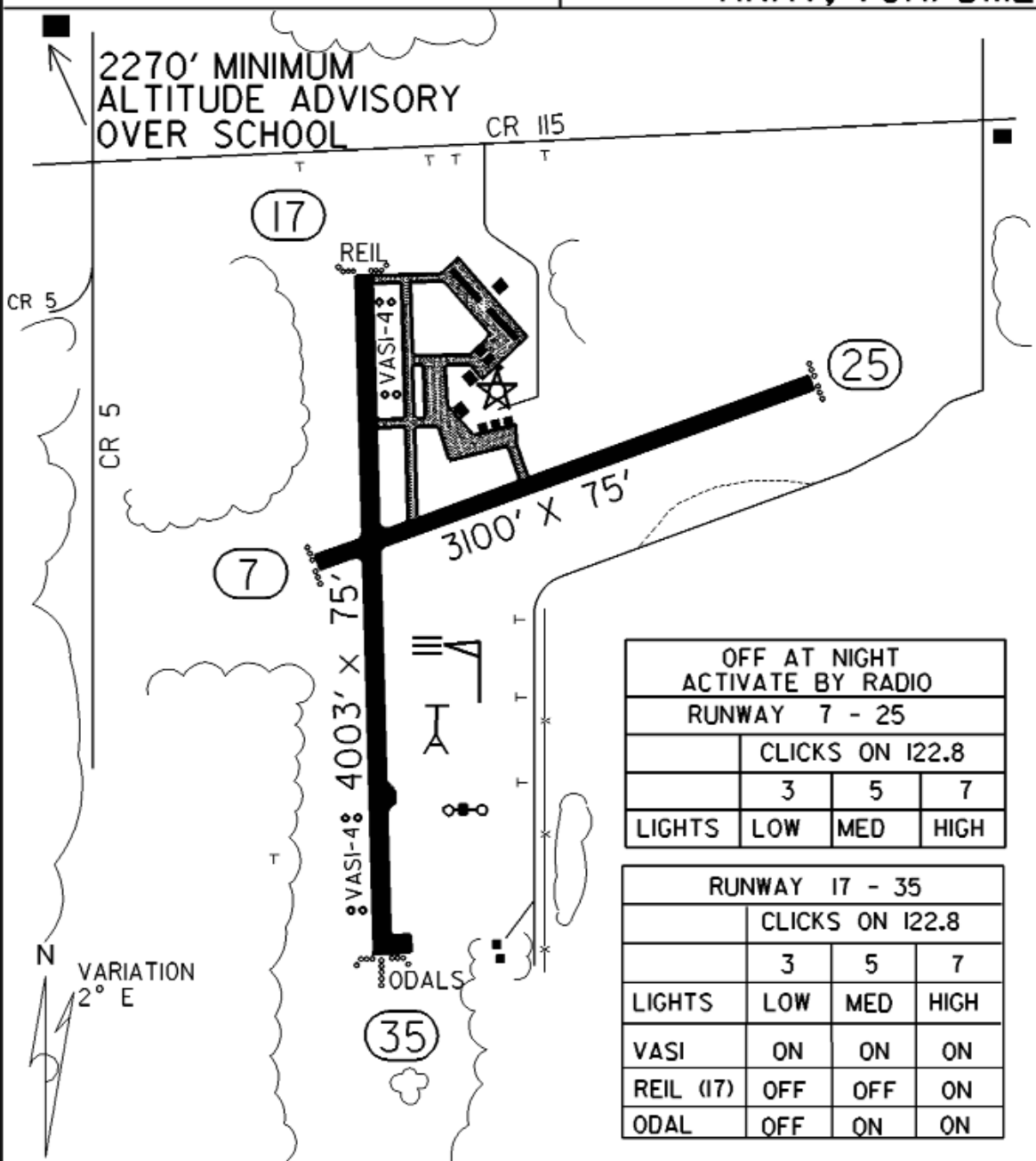

OFF AT NIGHT ACTIVATE BY RADIO			
RUNWAY 7 - 25			
CLICKS ON 122.8			
	3	5	7
LIGHTS	LOW	MED	HIGH

RUNWAY 17 - 35			
CLICKS ON 122.8			
	3	5	7
LIGHTS	LOW	MED	HIGH
VASI	ON	ON	ON
REIL (17)	OFF	OFF	ON
ODAL	OFF	ON	ON

CLOQUET-CARLTON COUNTY AIRPORT

CLOQUET