

## Bemidji - 96M

---



**Airport Manager:** Paul Grand - 218-444-9164 - [prgfish@yahoo.com](mailto:prgfish@yahoo.com)

**Contact Person:** Paul Grand - 218-444-9164 - [prgfish@yahoo.com](mailto:prgfish@yahoo.com)

**AWOS/ASOS:** 218-755-2575 VOR 110.0

**MnWAS Loc/Hrs:** NA

**Attended:** Unattended

**Fuel:** Mogas, 100LL

**Self Service Fuel:** Prior coordination required - 619-993-9164

**After Hrs Service:** See comments

**FBO(s):** None

**Businesses:** None

**Ground Transport:** None

**Food Service:** None

**Dining:** None

**Lodging:** None

**Airport Events:** None reported

**Underwing Camp:** No

**Campgrounds:** Bemidji State Park  
KOA  
Hamilton's

**Local Attractions:** Bemidji Town & Country Club; Castle Highlands; Greenwood Golf Course; Sandtrap Golf Course; Maple Ridge Golf Course; Statues of Paul Bunyan & Babe the Blue Ox; Bemidji State Park; 300 lakes & 88 resorts for fishing, swimming & boating; wooded areas for hunting, hiking, bike trails, cross-country skiing & campgrounds; Bemidji Woolen Mills; Concordia Language Village; Bemidji State University; first city on Mississippi River; Itasca State Park where you can visit the Headwaters of the Mississippi River

**Comments:** Airport manager's cell phone 619-993-9164  
Visitor's web site - [www.visitbemidji.com](http://www.visitbemidji.com)  
University web site - [www.bemidjistate.edu](http://www.bemidjistate.edu)

WATER ELEV. 1370'

(96M)

BEMIDJI

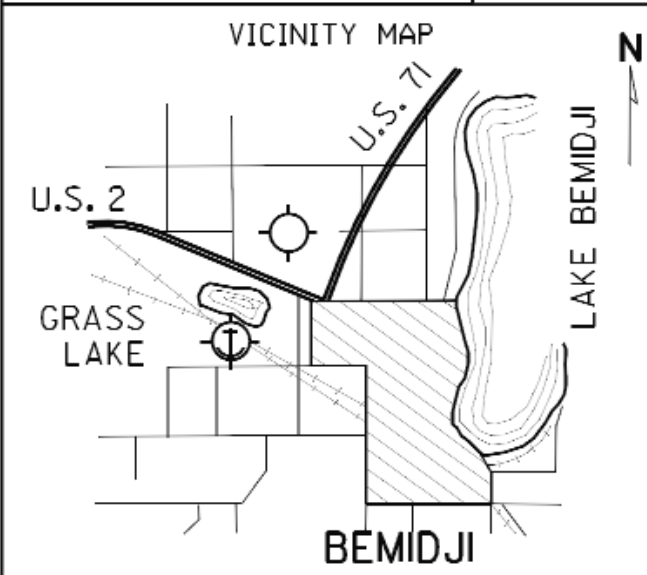

SEC. CH: TWIN CITIES (N)  
 LAT: 47° 30.0'  
 LONG: 94° 56.7'  
 COMM: CTAF: 122.9  
 AWOS: 110.0 VOR  
 MPLS CTR: 134.75  
 TPA: 1670' (300')

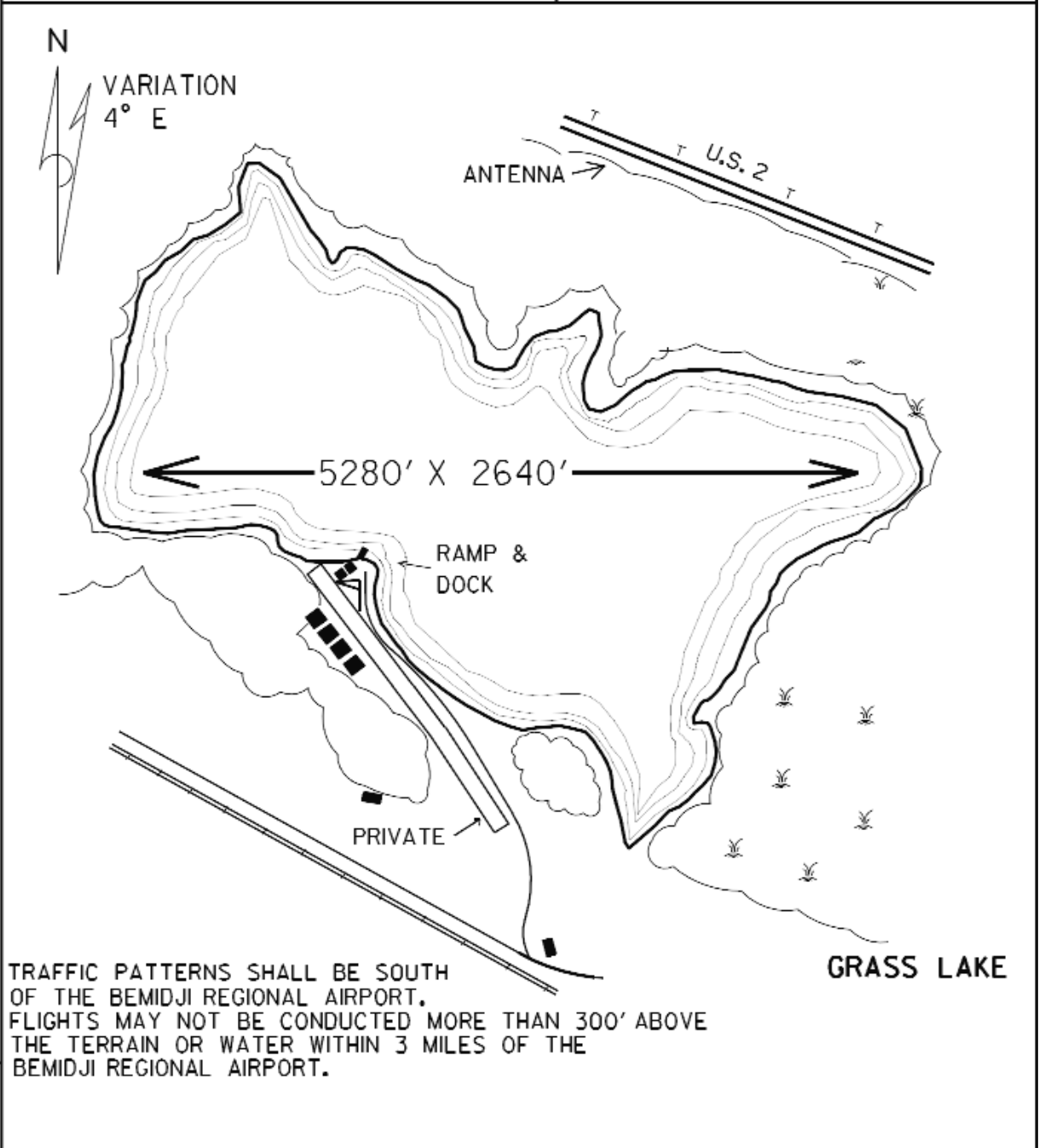
MOBERG AIR BASE

BEMIDJI