

TURF RUNWAY MARKING

GENERAL NOTES

1. THE TURF RUNWAY CONE MARKERS ARE CONFIGURED SIMILAR TO THE STANDARD RUNWAY LIGHTING PLAN. CONES MAY BE ADAPTED TO LIGHTS IN THE STANDARD CONFIGURATION.
2. IF DISPLACEMENT IS REQUIRED, APPROACH SURFACE MAY START AT DISPLACED THRESHOLD.
3. MARKERS SHALL BE PLACED IN PAIRS AT INCREMENTS OF 200 FEET OR LESS ON OPPOSITE SIDES OF THE TURF RUNWAY. SINGLE MARKERS MAY BE PLACED AT INTERSECTIONS.
4. MINOR SPACING VARIATIONS (BETWEEN 10 AND 15 FEET) MAY OCCUR TO THE RUNWAY END AND THE DISPLACED THRESHOLD MARKERS DUE TO RUNWAY WIDTH AND LOCAL OPERATING CONDITIONS SUCH AS SNOW REMOVAL, MOWING, GLIDERS, OVERRUN, ETC.
5. ALL MARKERS SHALL BE CONSTRUCTED OF DURABLE WEATHERPROOF MATERIAL.
6. COLOR OF MARKERS (NATURAL OR APPLIED) SHALL PROVIDE AN EFFECTIVE CONTRAST TO THE SURROUNDING AREA. MINNESOTA AERONAUTICS CONES ARE YELLOW.
7. CONSTRUCTION AND INSTALLATION SHALL BE SUCH THAT MARKERS WILL SHED SNOW AND NOT BECOME OBSCURED BY VEGETATION, DRIFTING SNOW OR SAND.

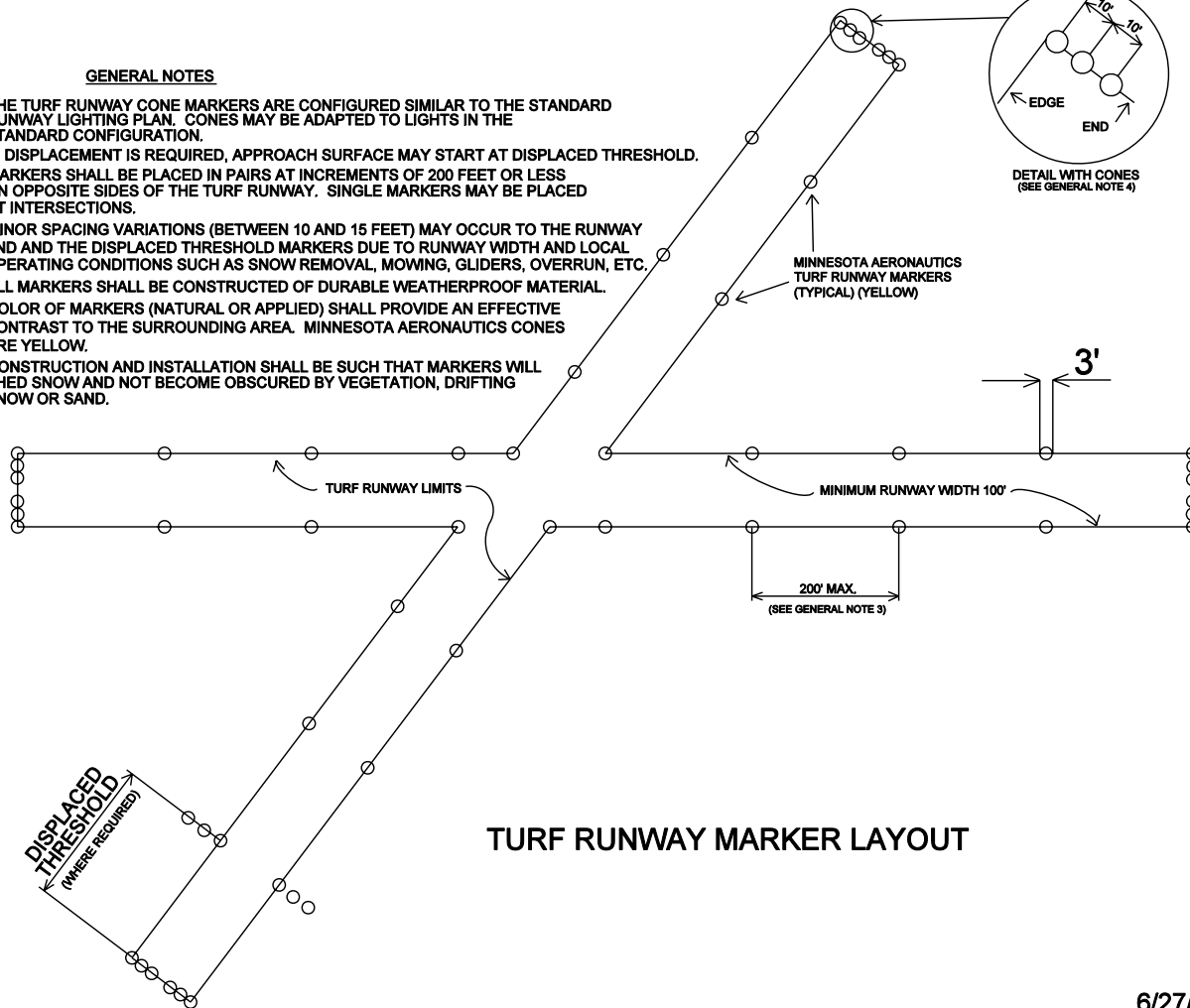
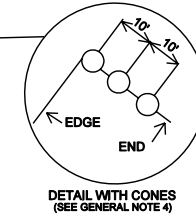

TURF RUNWAY MARKER LAYOUT

6/27/06